

## Load Ring VRBS-FIX welded on boltable plate VRBG-FIX-50t

Artikel-Nr: 7909951



Load ring threaded with full working load in all directions and split force introduction.

- Split force introduction due to multiple point fixing.
- Suspension ring pivots 180°.
- 100% WLL at 90 degrees in the load ring plane possible.
- Clear marking of the minimum WLL for all loading directions.
- Patented markings for easy determination for withdraw of service.
- Original RUD bolt available as spare part.
- Component according to the test criterias of BG/DGUV "GS-HM 36".
- Assembly with allen key possible.
- Hand tightening with appropriate wrench is sufficient for a singular lift. Please observe torque instructions when lifting point is permanently installed resp. at constant swivelling operations and tilting/ turning actions.

Other important RUD specific information and specialities to our RUD lifting points can be found in the specific user instruction.

## Load Ring VRBS-FIX welded on boltable plate VRBG-FIX-50t

Artikel-Nr: 7909951

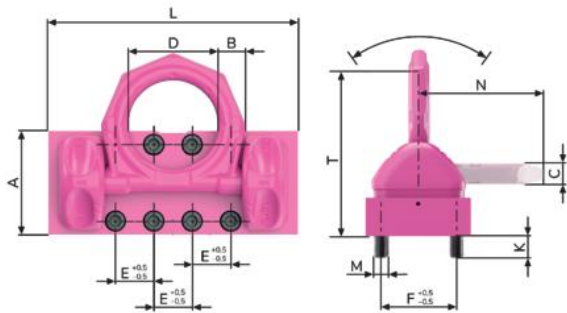

<b>weight</b>	204.00 kg	449.74 lbs
<b>Nominal WLL</b>	50000 kg	110230 lbs
<b>T</b>	430 mm	16-15/16"
<b>A</b>	270 mm	10-5/8"
<b>B</b>	70 mm	2-3/4"
<b>C</b>	55 mm	2-5/32"
<b>D</b>	230 mm	9-1/16"
<b>E</b>	100 mm	3-15/16"
<b>F</b>	200 mm	7-7/8"
<b>K</b>	60 mm	2-3/8"
<b>L</b>	650 mm	25-5/8"
<b>M</b>	M36 mm	M36
<b>N</b>	335 mm	13-3/16"